

**INVITATION FOR LETTERS OF INTEREST
TO OPERATE AND MAINTAIN AN ON-AIRPORT CATERING
FACILITY AT JOHN F. KENNEDY INTERNATIONAL AIRPORT**

January 30, 2026

**Aviation Department
Attn: Properties & Commercial Development
4 World Trade Center, 18th Floor
New York, NY 10007
Email: AVI_COMMERCIAL_IFO@PANYNJ.GOV**

The Port Authority of New York and New Jersey (Port Authority) invites firms that may be interested in a lease to operate and maintain an on-airport catering facility at John F. Kennedy International Airport (JFK) to submit a Letter of Interest.

An overview of the facilities under consideration for this Expression of Interest are attached as **Exhibit A** and **Exhibit B-1**.

Letters of Interest shall be transmitted and received by the Port Authority via email to: avi_commercial_ifo@panynj.gov not later than **4:00 P.M. EST. on February 27, 2026**. **Letters of Interest received after this time will not be accepted.**

Schedule

Deadline for Submitting Written Inquiries: 4:00 p.m. EST, February 11, 2026

Deadline for Submission of Letters: 4:00 p.m. EST, February 27, 2026

Submittal Requirements

Each firm desiring to respond to this request shall submit a Letter of Interest regarding leasing, operating and maintaining a catering kitchen at JFK. Letters of Interest shall relate to one or both buildings identified in this Expression of Interest.

- **Letter of Interest**: A concise letter of interest on company letterhead, limited to no more than 2 pages. The letter shall include i) the legal entity name of the interested firm(s); ii) a statement of interest; iii) a brief history of providing or overseeing catering kitchen facilities or other similar service(s) at an airport; iv) contact information for the designated representative, including but not limited to, name, address, telephone number and email address; and v) which facility the firm is interested in leasing.
- **Proposed Operational Overview**: A high-level overview of the proposed services that will be provided from one or both buildings under consideration, limited to no more than one page. If the plan requires procurement of a qualified tenant, a proposed timeline should be included.

Questions and Inquiries

Direct questions and inquiries regarding this Expression of Interest and scope of services, or any related matters to: avi_commercial_ifo@panynj.gov. Port Authority staff will not meet individually with interested parties to discuss this Request for Letters of Interest.

Exhibit A

Building 143 consists of approximately 36,000 square feet of space and approximately 2.8 acres of related land area, as depicted below.

Additional Details	
Property Type:	Industrial/Catering Kitchen
Stories:	One-story
Clearance Heights:	Approximately 13' to 30'
Office Space:	Yes (approximately 5%)
Direct AOA Access:	No

BUILDING 143
SITE PLAN

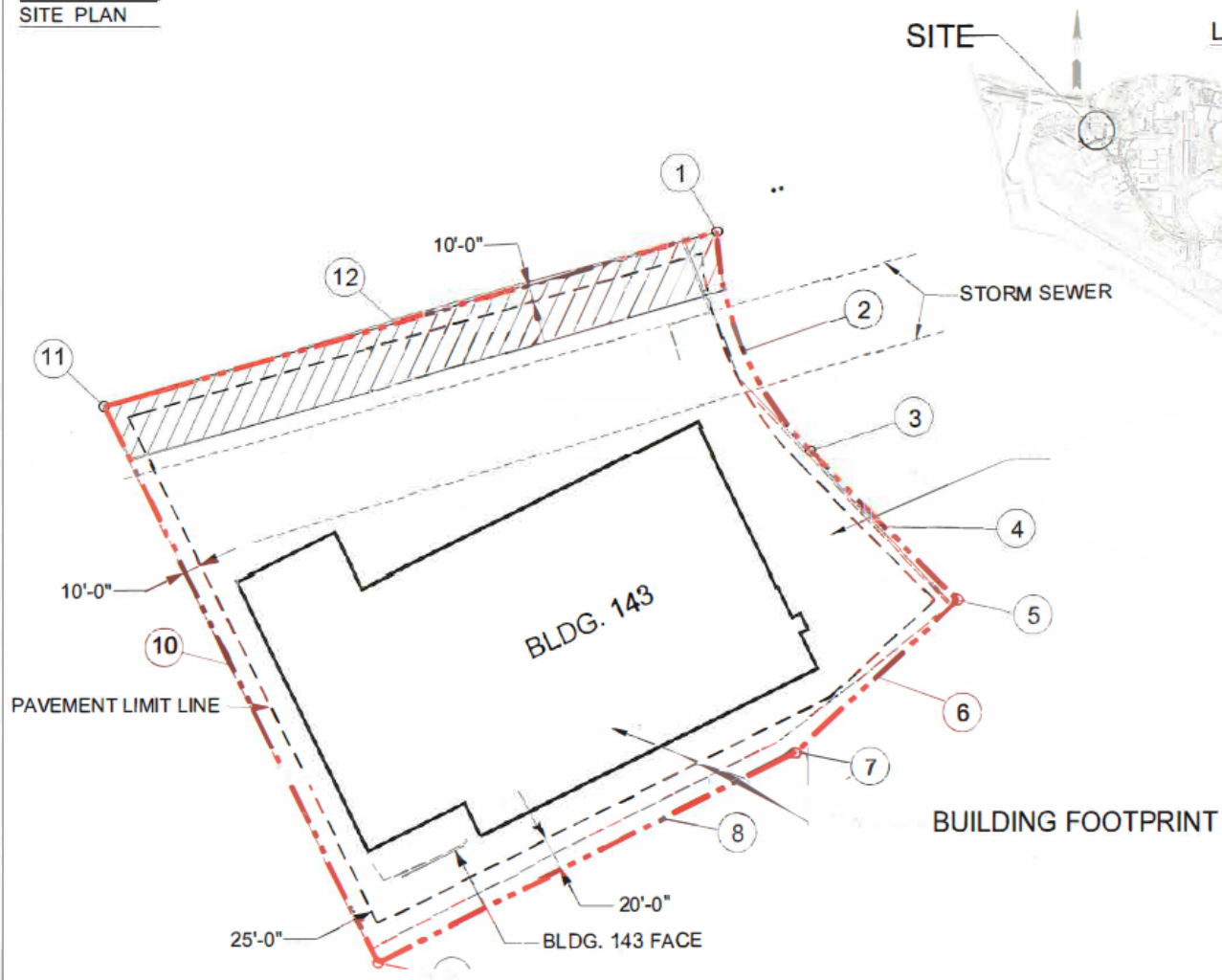
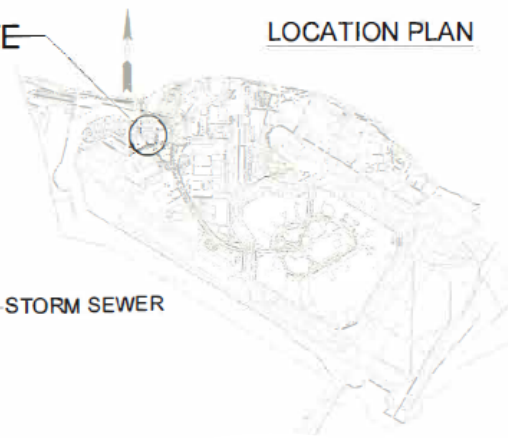

EXHIBIT A

LOCATION PLAN



DATA TABLE

(BEARINGS, COORDINATES
DISTANCES, RADIUS)

1	S 55,028.048 E 62,795.599
2	R = 194.00' L = 145.33' $\Delta = 42^\circ 55' 13''$ S 55,021.894 CC = E 62,989.501
3	S 55,158.444 E 62,851.697
4	S 44° 58' 22" E 125.00'
5	S 55,246.874 E 62,940.043
6	S 47° 06' 43" W 132.37'
7	S 55,336.963 E 62,843.055
8	S 63° 34' 45" W 280.00'
9	S 55,461.552 E 62,592.301
10	N 26° 32' 32" W 368.63'
11	S 55,131.770 E 62,427.575
12	N 74° 15' 37" E 382.36'

NOTE:
COORDINATES, EXPRESSED IN FEET,
AND BEARING REFER TO THE GRID
SYSTEM OF THE BOROUGH OF
QUEENS TOPOGRAPHICAL BUREAU.

THE PORT AUTHORITY OF NEW YORK AND NEW JERSEY
JOHN F. KENNEDY
INTERNATIONAL AIRPORT
10 - 12 - 17 (BLDG 143-0) JFK09 - 008

Exhibit B-1

Building 139 consists of approximately 132,890 square feet of space and Building 137 consists of approximately 4,000 square feet. The total site, inclusive of Buildings 139 and 137, is 7.2 acres of related land area, as depicted below.

<u>Additional Details</u>		
Building Number	139	137
Property Type	Industrial/Catering Kitchen	Vehicle Maintenance Facility
Stories	Two-stories	One-story
Clearance Heights	Approximately 10' to 14'	Approx. 18'
Office Space	Yes (approximately 9%)	No
Direct AOA Access	No	No
Elevators	3 freight elevators	N/A

BUILDING 137
SITE PLAN

BUILDING 139
SITE PLAN

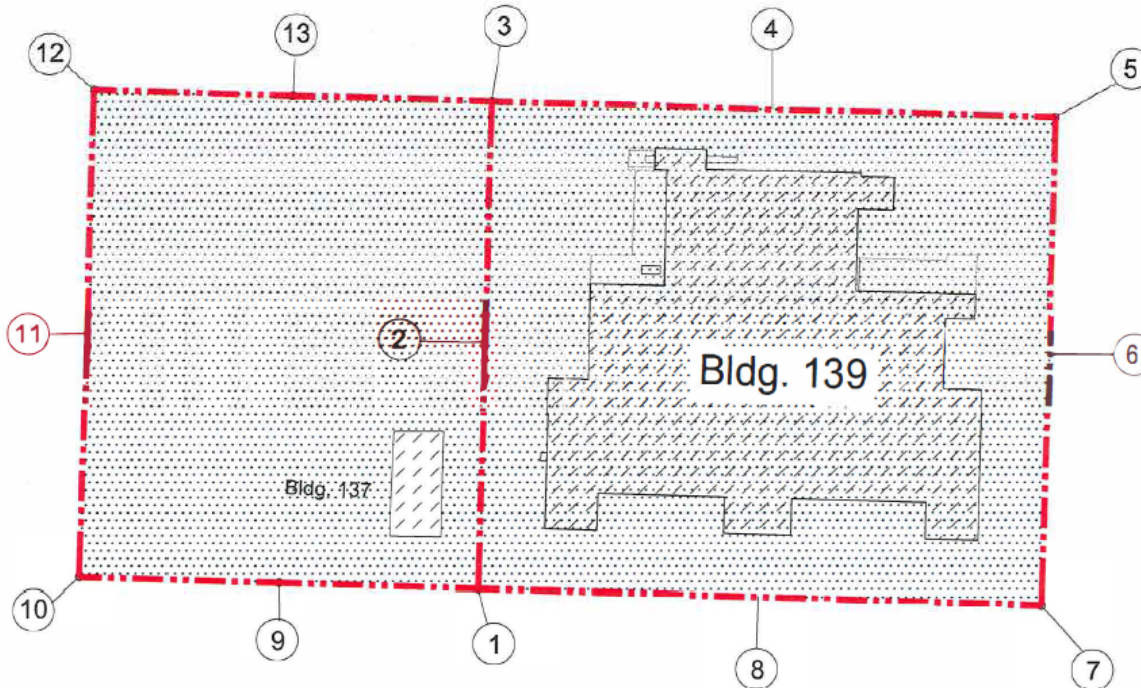
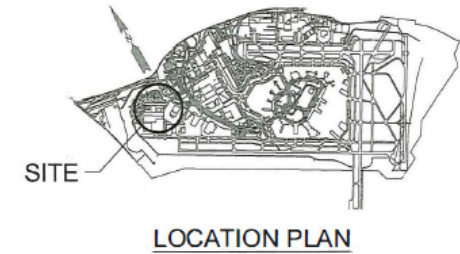

DATA TABLE

(BEARINGS, COORDINATES, DISTANCES, RADIUS)

1	S 57,211.773 E 61,472.565	8	N 88° 21' 00" W 460.00'
2	N 01° 39' 00" E 400.00'	9	N 88° 21' 00" W 325.00'
3	S 56,811.939 E 61,484.082	10	S57,202.414 E61,147.700
4	S 88° 21' 00" E 460.00'	11	N 01° 03' 00" E 400.000'
5	S 56,825.184 E 61,943.891	12	S56,802.581 E61,159.218
6	S 01° 39' 00" W 400.00'	13	S 88° 21' 00" E 325.000'
7	S 57,225.018 E 61,932.374		

NOTE:

COORDINATES, EXPRESSED IN FEET, AND BEARING REFER TO THE GRID SYSTEM OF THE BOROUGH OF QUEENS TOPOGRAPHICAL BUREAU.

THE PORT AUTHORITY OF NEW YORK AND NEW JERSEY

**JOHN F. KENNEDY
INTERNATIONAL AIRPORT**

10-12-17

(137/139-0)

JFK08-031

EXHIBIT B-1