

FAA Update

Session Moderator

Greg Albjerg
Vice President & Senior
Aviation Consultant
HNTB

Session Panelists

Katherine Andrus
Manager, Environmental
Policy & Operations Division
FAA Office of Environment
& Energy

Steve Debban
National Resource Expert for
Airport Design
FAA Office of Airports

Mike Hines
Manager, Planning &
Environmental Division
FAA Office of Airports

We are
Airports

Airport Engineering Updates

ACI-NA/ACC Planning & NEPA Workshop

Steven Debban, P.E.

National Resource Expert for Airport Design, AAS-100



FAA
Office of Airports

Adv, Circ. AC 150/5300-13B Airport Design

Reorg, Update

Policy Revisions

AC 150/5300-13B General Reorganization

-13A, Change 1

- Passive language
- Defines “DO NOT” practices
- Defines operational practices
- Outside of standards scope and/or duplicative to other guidance
- Outdated design Figures
- Voluminous Tables

-13B Draft

- Clarifies standard vs. recommendation
- Uses positive language – “DO” practices
- Operational practices to Appendices
- Eliminates duplicative language, references
- Modernizes and revises design Figures
- Online tables or Appendices as applicable

AC 150/5300-13B Figures Update

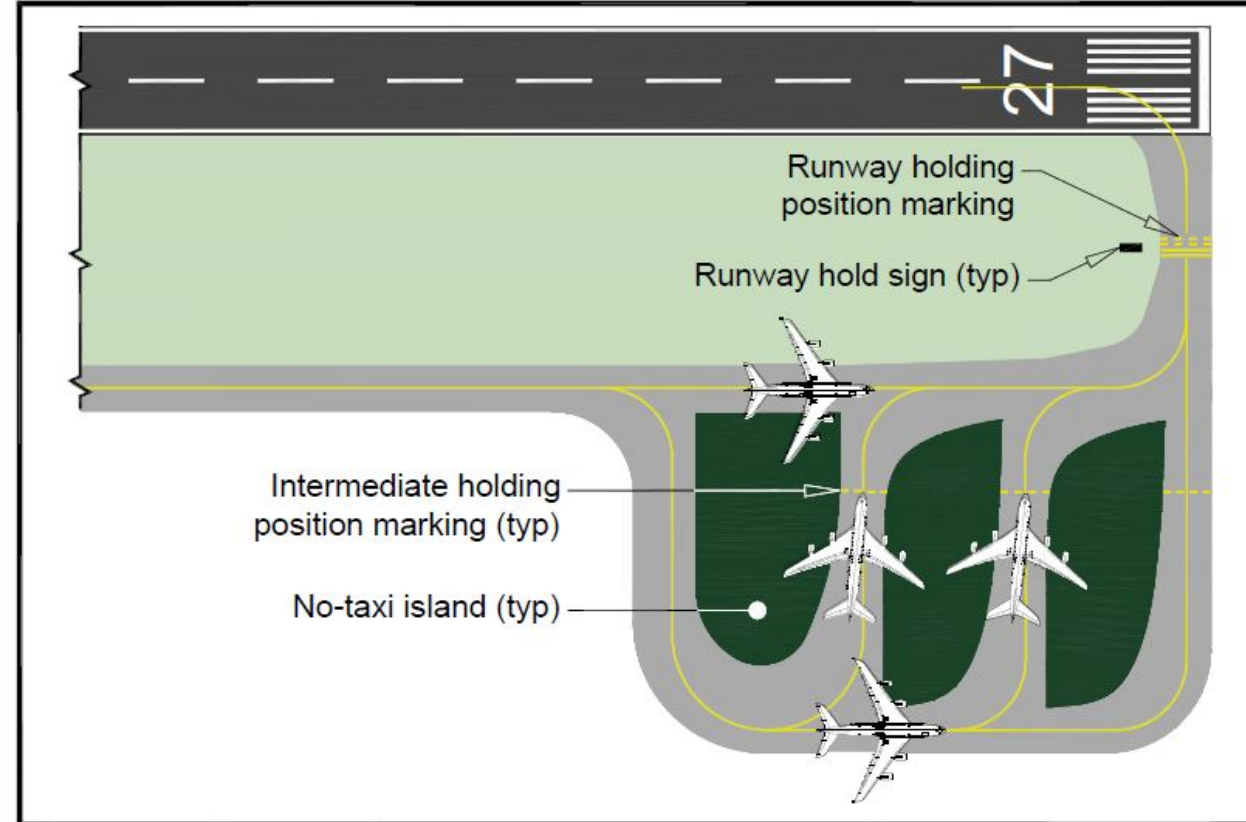
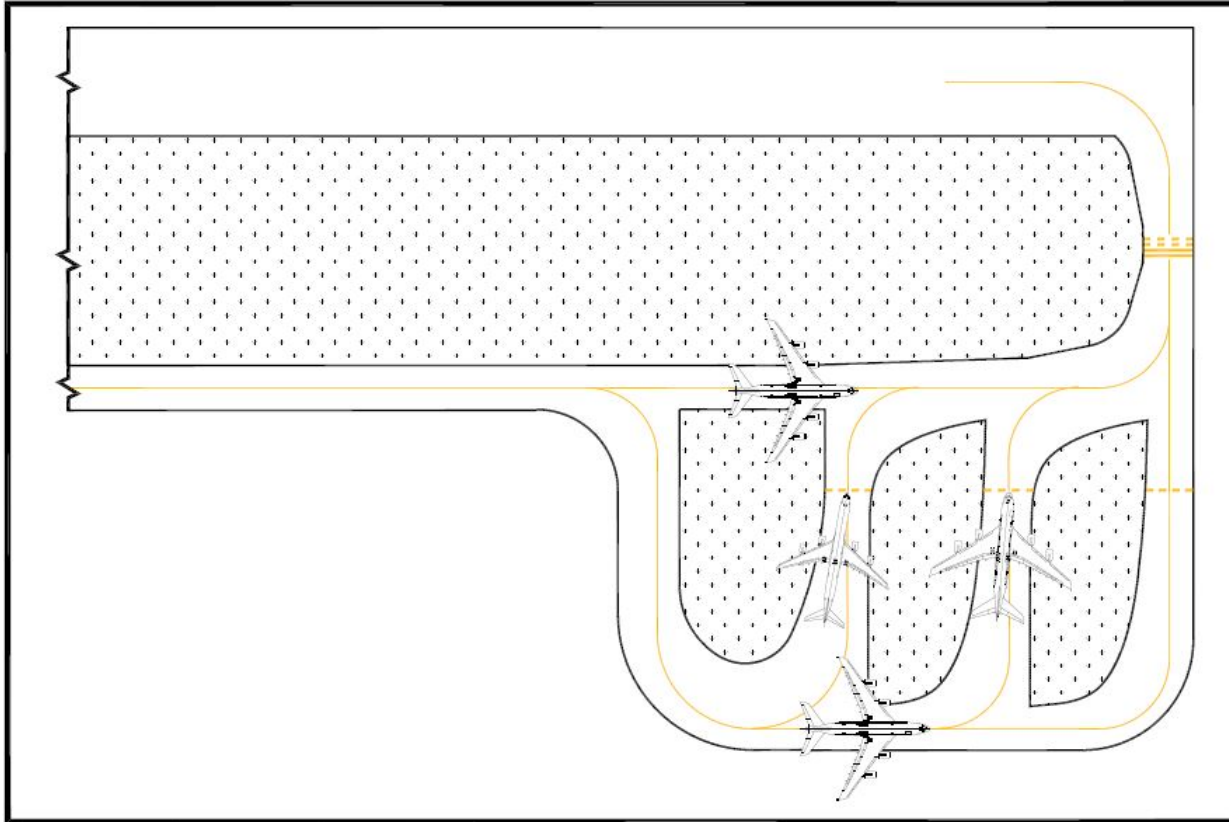

AC 150/5300-13B Draft Policy Revisions

Taxiway OFAs

Parallel Taxiway Definition

Critical Aircraft Nomenclature

TERPS Criteria Updated (EB 99)

TESM/TDG 7 Revisions

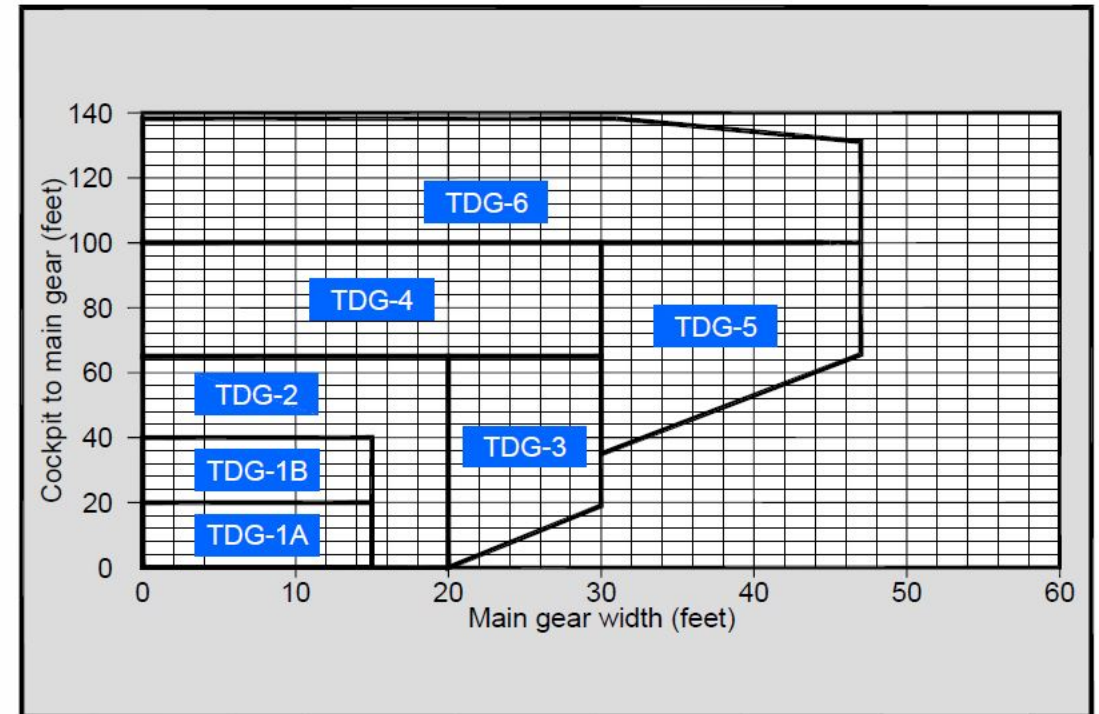

AC 150/5300-13B Draft Policy Revisions

Parallel Runways

Clarified perpendicular hold positions

Focused discussion on RIM

Enhanced discussion on WSE

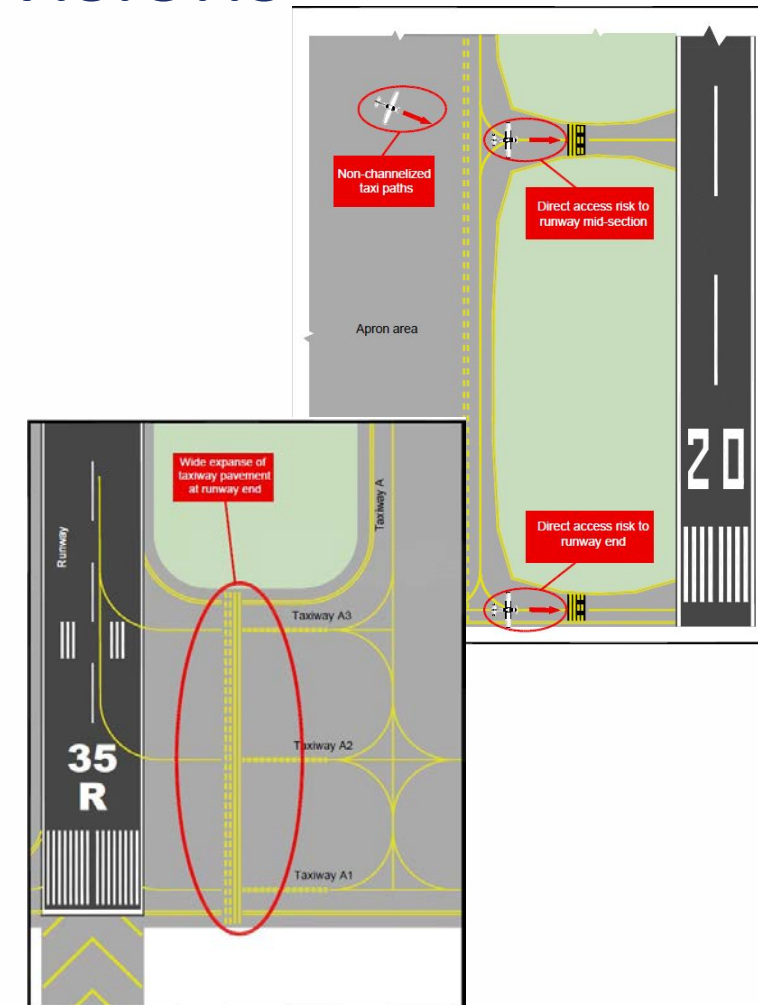

RIM Program Stats

RIM Locations

- 136 RIM Locations
- 15 New locations from CY 2018
- 13 mitigated in FY 2019
- http://www.faa.gov/airports/special_programs/rim/

Program Statistics

- 520 towered airports
- 79 airports w/ RIM
- 100+ RIM locations associated w/ mitigation project
 - 15 Construction
- 44 RIM locations completed projects
 - 491 RIs pre-, 23 RIs post-mitigation

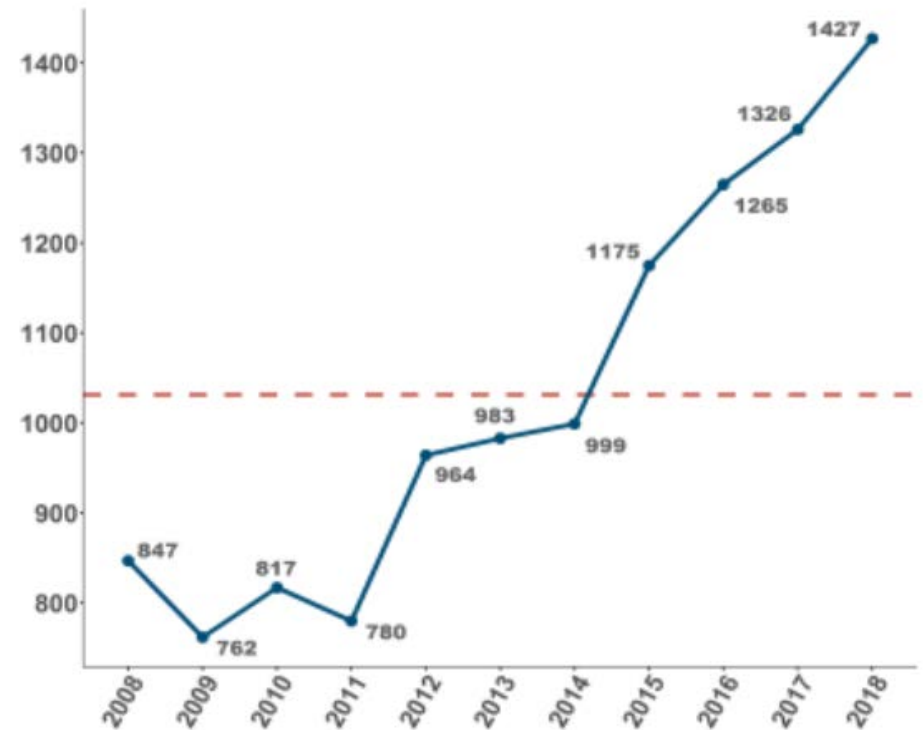

Total Annual Incursions Analyzed

RIM Role in Planning

RIM Locations

Identifies potential locations

Integrate into CIPs



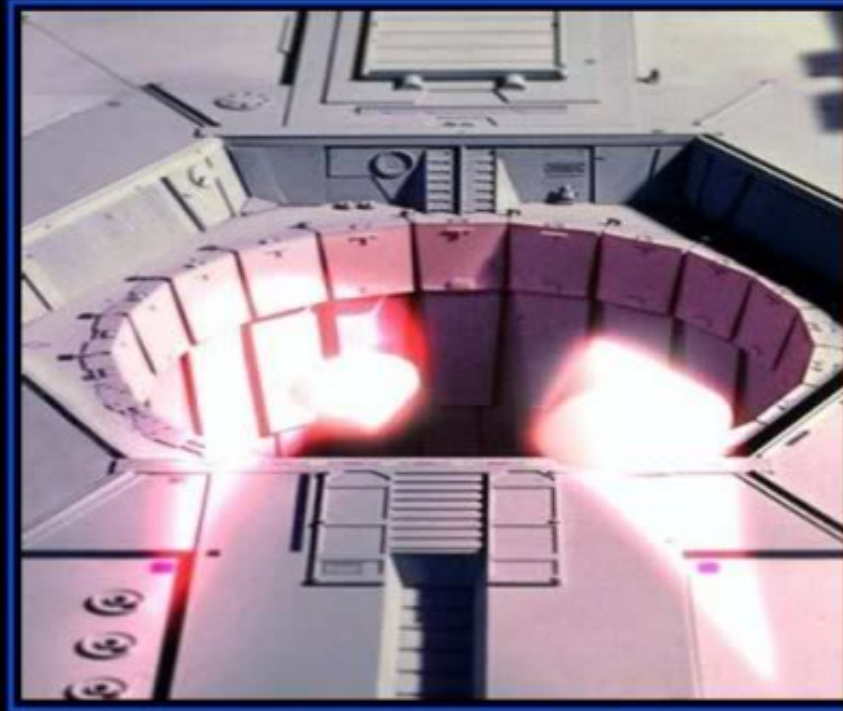

ENGINEERING

YOU MAY THINK THAT A THERMAL EXHAUST PORT FROM THE CENTRAL REACTOR CORE IS A GOOD IDEA, BUT THINK OF THE CONSEQUENCES.

ICANHASFORCE.COM

Questions?